

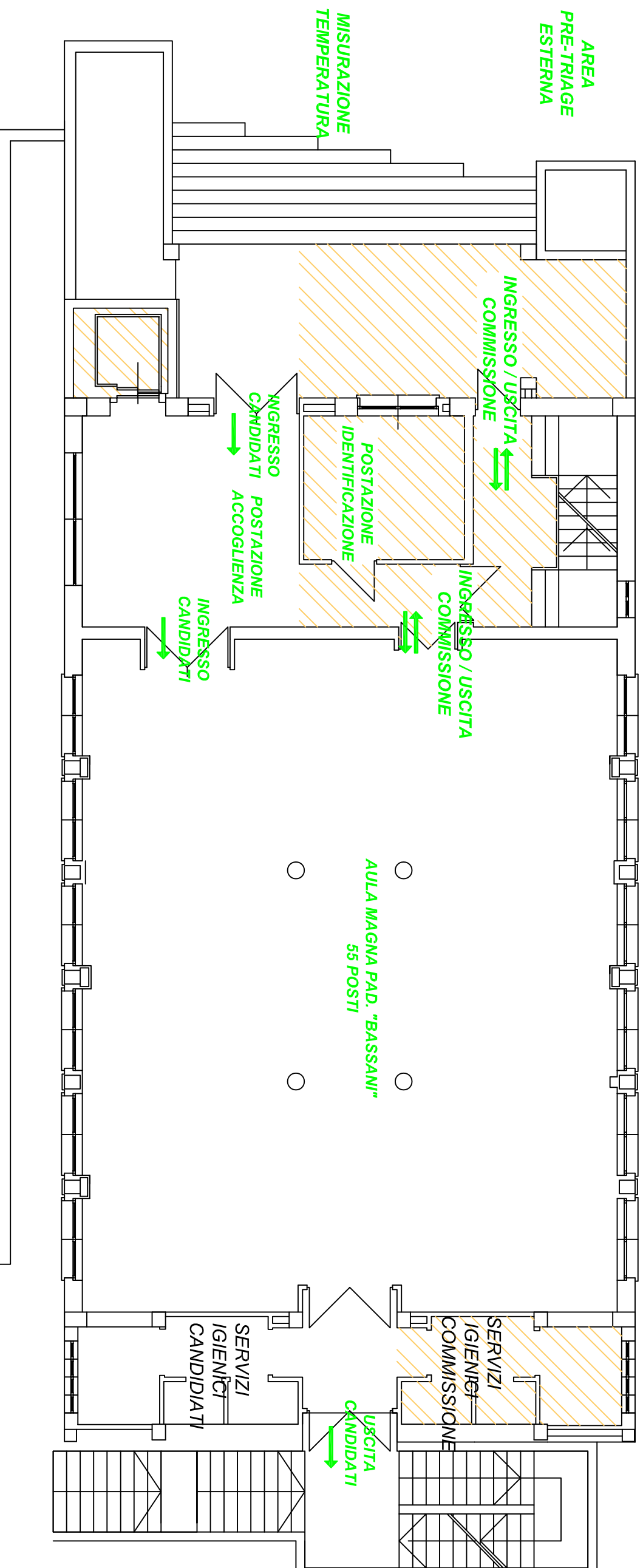

LOCALE	mq		
Br1 - atrio -0.004.0	30,06	Br5 - bagni 0.010.0 0.010.1-0.010.2-0.010.3	10,11
Br2 - ufficio -0.003.0	11,45	Br6 - disimpegno -0.007.0	7,02
Br3 - scale -0.001.0	15,56	Br7 - bagni 0.008.0 0.008.1-0.008.2-0.008.3	10,18
Br4 - aula magna -0.005.0-0.006.0	174,59	TOTALE P. TERRA - Mq 258,97	



AREA INTERDETTA AI CANDIDATI